



- NOTES:**
- IDF 2 in Room 1**
- ❑ Install a new Panduit Slim Line Cabinet on the N/E Wall in Room 1
  - ❑ Include 10' of 2" conduit from ceiling to cabinet including supporting brackets
  - ❑ Vendor to install 24 port patch panel into cabinet
  - ❑ Install, including terminate 12 new CAT6 cables between IDF and rooms 1-3
- IDF 1 to IDF 2**
- ❑ Verify existing fiber between IDF1 and IDF2, reuse if passes tests
  - ❑ Splice new pigtailed if needed to accommodate placing fiber into newly installed cabinet in IDF 2



LEGEND	
	DATA (Wall)
	DATA (Ceiling)
	DATA w/AP
	Outside DATA w/AP
	MDF Main Distribution Feed
	IDF Intermediate Distribution Feed
	MPOE Main Point of Entry (If not in MDF)



Rev #	1	PAGE	7 OF 26
FILENAME	BULJAN - BU.VSDX	Date Created / Revised	2015-09-28 / 2015-09-28
 E-Rate FY2024			

TITLE	BULJAN MIDDLE SCHOOL
DESCRIPTION	eRate FY2024 RFP24-919

Address:  
 100 Hallissy Drive  
 Roseville CA 95678  
 916-771-1720



**NOTES:**

**IDF 2 in Room 1**

- Install a new Panduit Slim Line Cabinet on the N/E Wall in Room 1
- Include 10' of 2" conduit from ceiling to cabinet including supporting brackets
- Vendor to install 24 port patch panel into cabinet
- Install, including terminate 12 new CAT6 cables between IDF 2 and rooms 1-3
- All cable runs will have 2 data cables each
  - General location noted in drawing, final placement before work commences
  - Cables designated with W will be terminated in the ceiling for wireless access (see figure)
  - All others will be terminated in a vendor provided 1 gang low voltage box where needed
- Install new or use existing raceway as needed
  - Include 30' of raceway in quote to cover costs as needed

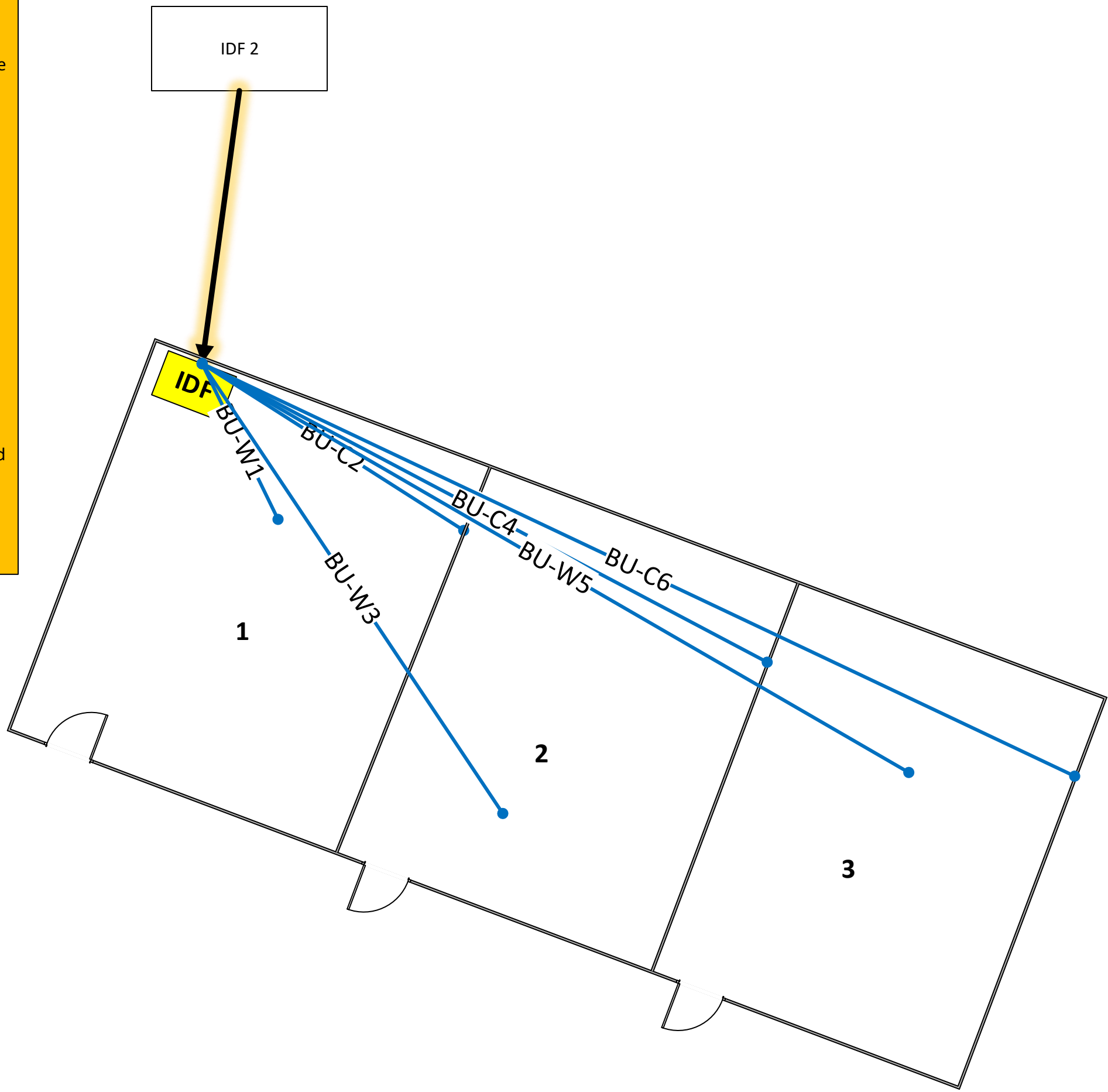

**LEGEND**

- DATA (Wall)
- DATA (Ceiling)
- DATA w/AP
- Outside DATA w/AP
- MDF Main Distribution Feed
- IDF Intermediate Distribution Feed
- MPOE Main Point of Entry (If not in MDF)



Rev #	1	PAGE	8 OF 26
FILENAME	BULJAN - BU.VSDX	Date Created / Revised	2015-09-28 / 2015-09-28

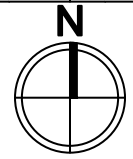

E-Rate  
FY2024

Address:	TITLE	BULJAN MIDDLE SCHOOL
	DESCRIPTION	eRate FY2024 RFP24-919
100 Hallissy Drive Roseville CA 95678 916-771-1720		



**NOTES:**

**IDF 5 Room 1**

- Replace existing CAT5 with CAT6 in existing conduit. Use OSP if required
- Install new 1-Gang on external of building at existing Access Point placement for Data Jack
- Provide weather proof whip from 1-Gang to the existing Access Point.
- Existing cable has been tested to be 220'.

**NOTE:**  
 Green Highlight is inside run  
 Purple Highlight is external run in conduit

IDF5

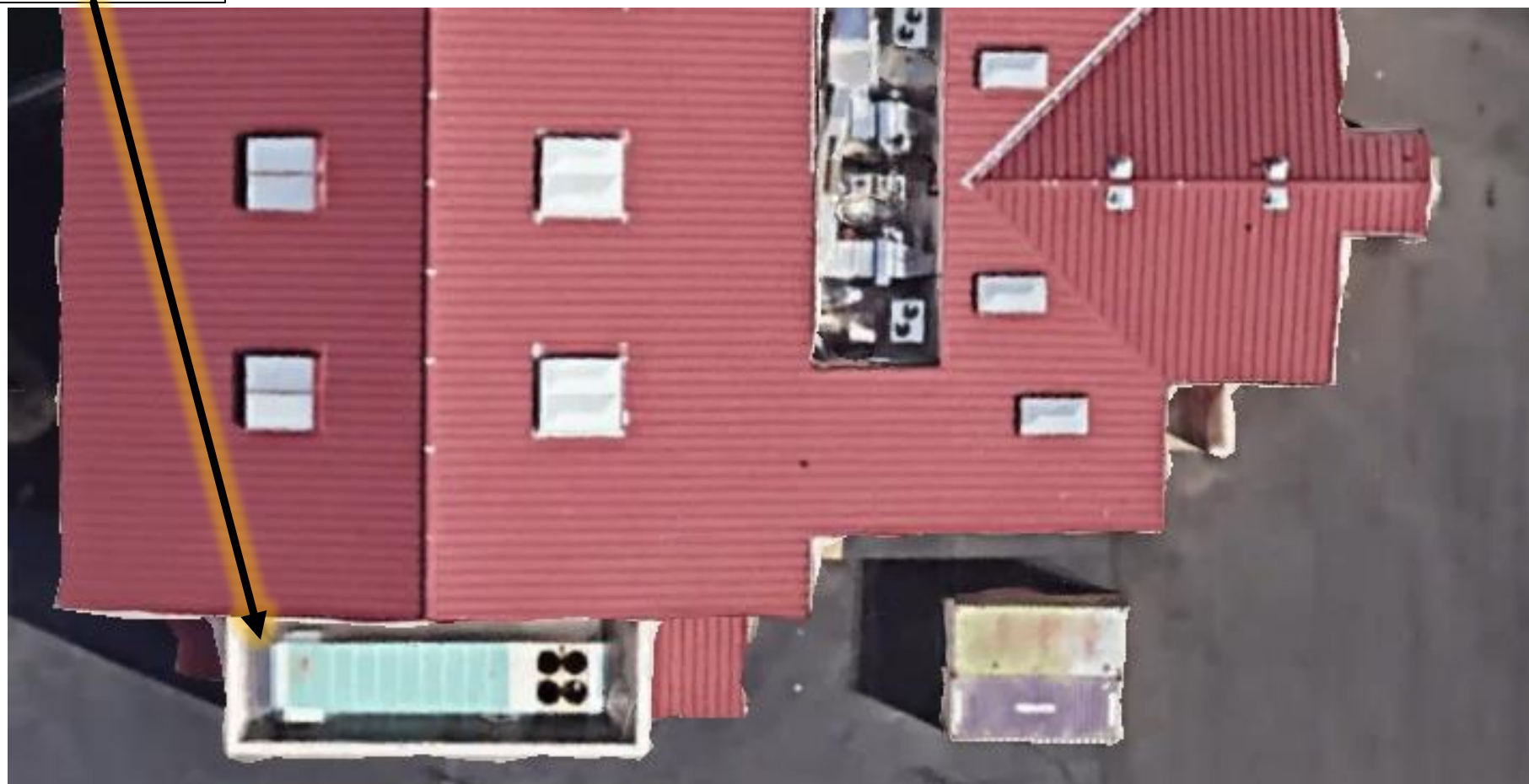

**LEGEND**

- DATA (Wall)
- DATA (Ceiling)
- DATA w/AP
- Outside DATA w/AP
- MDF** Main Distribution Feed
- IDF** Intermediate Distribution Feed
- MPOE** Main Point of Entry (If not in MDF)



Rev #	1	PAGE	9 OF 26
FILENAME	BULJAN - BU.VSDX	Date Created / Revised	2015-09-28 / 2015-09-28



E-Rate  
FY2024

TITLE	<b>BULJAN MIDDLE SCHOOL</b>
DESCRIPTION	eRate FY2024 RFP24-919
Address:	100 Hallissy Drive Roseville CA 95678 916-771-1720



**NOTES:**

**New IDF in Room 6**

- Install a new Panduit Slim Line Cabinet on the N/W Wall in Room 6
- Include 5' of 2" conduit from ceiling to cabinet including supporting brackets
- Vendor to install 24 port patch panel into cabinet
- Install, including terminate 12 new CAT6 cables between IDF and rooms 6-8
- Install or use existing raceway as needed

**MDF to Room 6**

- Verify if existing CAT6 OSP will pass tests and if able to be placed into newly installed Panduit Cabinet.
  - Quote as Optional**
  - If the existing CAT6 OSP cable fails or isn't movable:
  - Install new 62.5 micron fiber between MDF and new cabinet in Room 6



New IDF in RM 6

MDF

**LEGEND**

- DATA (Wall)
- DATA (Ceiling)
- DATA w/AP
- Outside DATA w/AP
- MDF** Main Distribution Feed
- IDF** Intermediate Distribution Feed
- MPOE** Main Point of Entry (If not in MDF)



Rev # 1  
PAGE 10 OF 26

FILENAME  
Date Created / Revised  
2015-09-28 / 2015-09-28

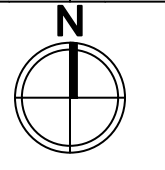

E-Rate  
FY2024

TITLE  
**CIRBY ELEMENTARY SCHOOL**

DESCRIPTION  
eRate FY2024 RFP24-919

Address:  
814 Darling Way  
Roseville CA 95678  
916-771-1730

**NOTES:**

**New IDF in Room 6**

- Install a new Panduit Slim Line Cabinet on the N/W Wall in Room 6
- Vendor to install 24 port patch panel into cabinet
- Install, including terminate 12 new CAT6 cables between IDF and rooms 6-8
- Install or use existing raceway as needed
  - Include 30' of raceway in quote to cover costs as needed

**MDF to Room 6**

- Verify if existing CAT6 OSP will pass tests and if able to be placed into newly installed Panduit Cabinet.
  - Quote as Optional**
  - If the existing CAT6 OSP cable fails or isn't movable:
  - Install new 62.5 micron fiber between MDF and new cabinet in Room 6

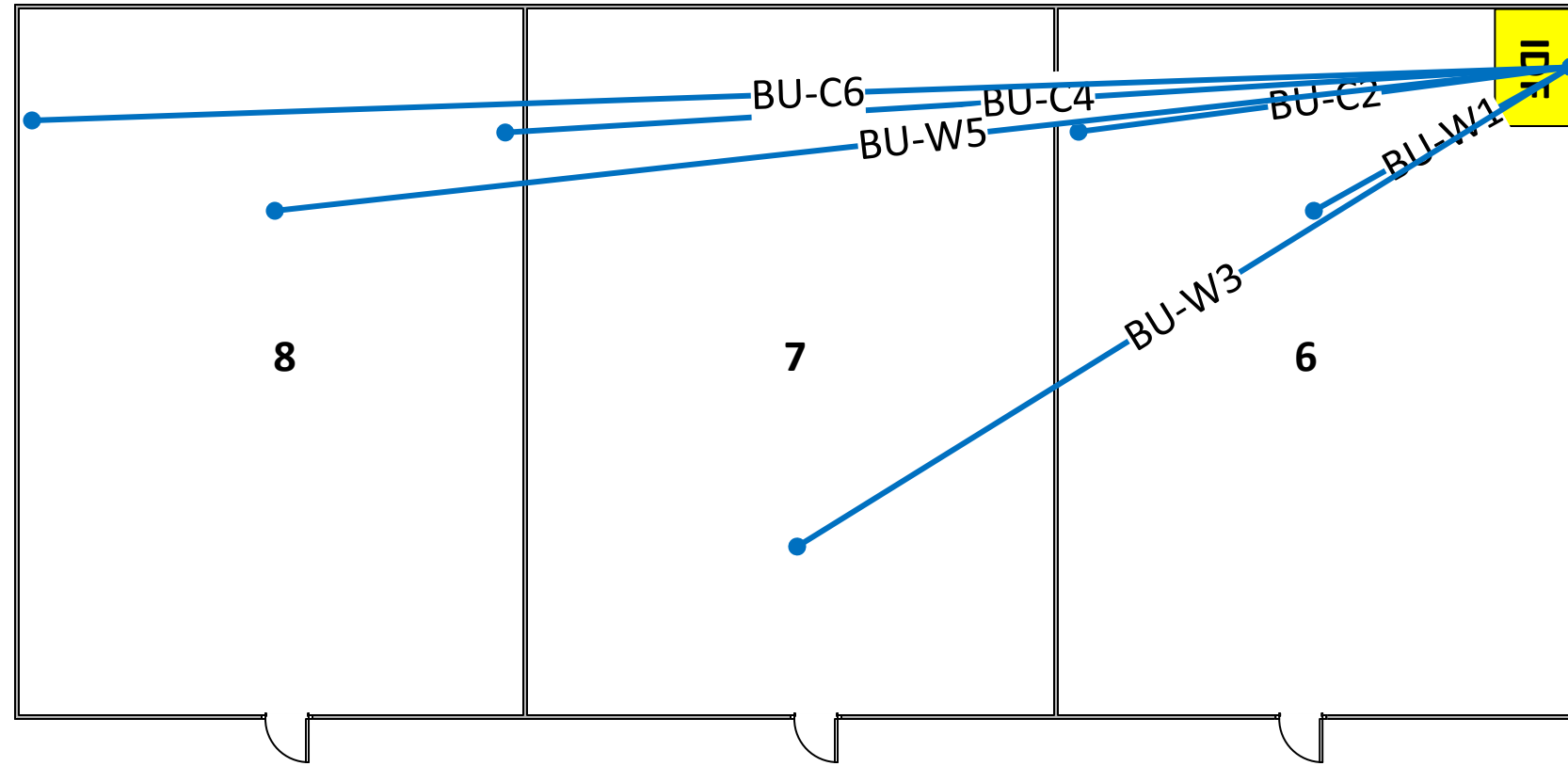

**LEGEND**

- DATA (Wall)
- DATA (Ceiling)
- DATA w/AP
- Outside DATA w/AP
- MDF** Main Distribution Feed
- IDF** Intermediate Distribution Feed
- MPOE** Main Point of Entry (If not in MDF)



Rev # 1  
PAGE 11 OF 26

FILENAME  
Date Created / Revised  
2015-09-28 / 2015-09-28

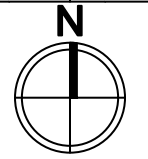

E-Rate  
FY2024

TITLE	Cirby Elementary School
DESCRIPTION	eRate FY2024 RFP24-919

Address:  
814 Darling Way  
Roseville CA 95678  
916-771-1730